

## RECESSED CEILING AIR DEHUMIDIFIER MODEL CTO-6800 STD

Technical sheet with latest revision 10/2023

Suitable for apartments, houses, villas, residences, hotels, small exhibitions, taverns, homes, second homes, technical studios, offices, meeting rooms, waiting rooms, medical offices and more.

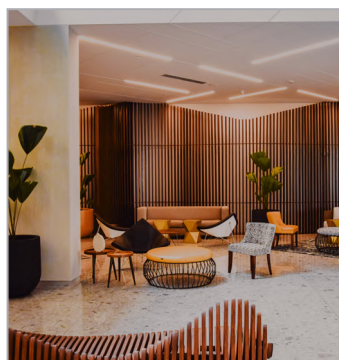

**CODE**

**Product code:** CTO-6800 STD

**Supplier:** TECNOKLIMA SRL  
Via della Repubblica, 1 ABCD 40057 Granarolo dell'Emilia (BO) Italy  
Telephone (+39) 051/6056846 - 051/6066593 - Fax (+39) 051/761367  
Email [info@tecnoklima.it](mailto:info@tecnoklima.it) - [assistenza@tecnoklima.it](mailto:assistenza@tecnoklima.it)  
Web site: [www.tecnoklima.it](http://www.tecnoklima.it)

**DESCRIPTION**

Recessed ceiling dehumidifiers ideal for cooling systems with radiant panels in residential applications. This range of dehumidifiers has been designed to be inserted in the thickness of the false ceiling, in order to control the relative humidity in homes, offices, meeting rooms and in particular in those environments where a floor or wall conditioning system is used. They are characterized by excellent silent operation even at the highest revs with low speed fan and built-in silencer. Of particular note is the extremely low energy consumption. Equipped with a sturdy structure in galvanized sheet metal, our dehumidifiers are equipped with an electronic board for managing functions. The installation is extremely simple, the machine is normally housed in the thickness of the false ceiling and, as a rule, it is sufficient to provide an adequate power supply and the preparation of the condensate drain.

The ceiling units are direct expansion refrigerant circuits equipped with a compressor and equipped differently according to the versions. They are subject to ordinary maintenance - periodic cleaning of the dust collector filter - and must be installed in compliance with the basic rules for extraordinary maintenance or repairs that are required. Large hatches must be provided in the false ceiling for periodic inspections and any uninstillation must be foreseen if, for technical reasons, it should be necessary. Any inspection must also be possible along the entire path of the condensate drain in order to verify its integrity over time and ensure that it is replaced or cleaned if necessary.

CTO recessed ceiling dehumidifiers ideal for environments with radiant air conditioning, such as: apartments, houses, villas, residences, hotels, small exhibitions, taverns, wine bars, homes, second homes, technical studios, offices, meeting rooms, meeting rooms waiting, doctor's offices, etc.

**VERSIONS**

The CTO-6800 STD recessed ceiling dehumidifier must necessarily be connected to the cooling water circuit of the premises. Activation is foreseen only if cold water is available at the foreseen temperatures and flow rates. They are dehumidifiers suitable for installation in cooled rooms with radiant panel systems. It is therefore not recommended to use the machine in environments with temperatures below +15°C. STD units are equipped with on-board pre- and post-cooling coils. Our dehumidifiers must always be positioned indoors and are designed to treat clean air, free from traces of dust, chemical vapours, oil mists, aggressive materials or other pollutants or explosive atmospheres.

**CHARACTERISTICS**

- Internal soundproofing linings
- 3-speed axial fan
- Filter mounted on the machine
- I use R134a ecological gas
- Hermetic compressor
- Extreme versatility of use
- Hour meter on the machine
- Recessed to false ceiling

**CTO-6800 STANDARD dehumidifier (1)**

Dehumidifier designed for installation in false ceilings, with the aim of controlling humidity in environments with a radiant system.

**Muffler (2)**

sound-absorbing silencer in galvanized sheet (optional).

**Plenums (3)**

Galvanized sheet metal plenum complete with collars for connection of process air ducting lines (optional).



Average nominal absorbed power (25°C - 60% rh - water 16°C)	850 W
Maximum absorbed power(32°C - 95% rh)	910 W
Maximum absorbed current (32°C - 95% rh)	5,5 A
Inrush current FLA	25 A
Air flow (with clean filter)	550
Air flow range	500-680
Usable static pressure	56-22 Pa
Sound pressure level Lps (at 3 meters in free field)	40 db(A)
Refrigerant	R134a
Water attacks IN/OUT	1/2"
Condensate drain connection (rubber hose)	16 mm
Temperature operating range	15-33°C
RH operating range	40-95%
Cooling function total cooling capacity (25°C - 65% rh - water 16/18°C)	-
Sensible cooling capacity Cooling function (25°C - 65% rh - water 16/18°C)	-
Cooling water flow rate (inlet temp. 16°C)	360 l/h
Cooling water pressure drop (inlet temp. 16°C)	25 kPa

Inlet water temperature never lower than +16°C, due to possible formation of undesirable and dangerous phenomena of condensation and/or ice.

IN/OUT water temp	23°C - 55%	23°C - 65%	25°C - 55%	25°C - 65%	27°C - 65%	30°C - 80%
16/20°C	2 8 l/24h	38 l/24h	32 l/24h	44 l/24h	52 l/24h	68 l/24h

The condensing capacity shown indicates the punctual, instantaneous capacity of the unit, in the absence of defrost pauses normally present in the unit.

DIMENSIONAL

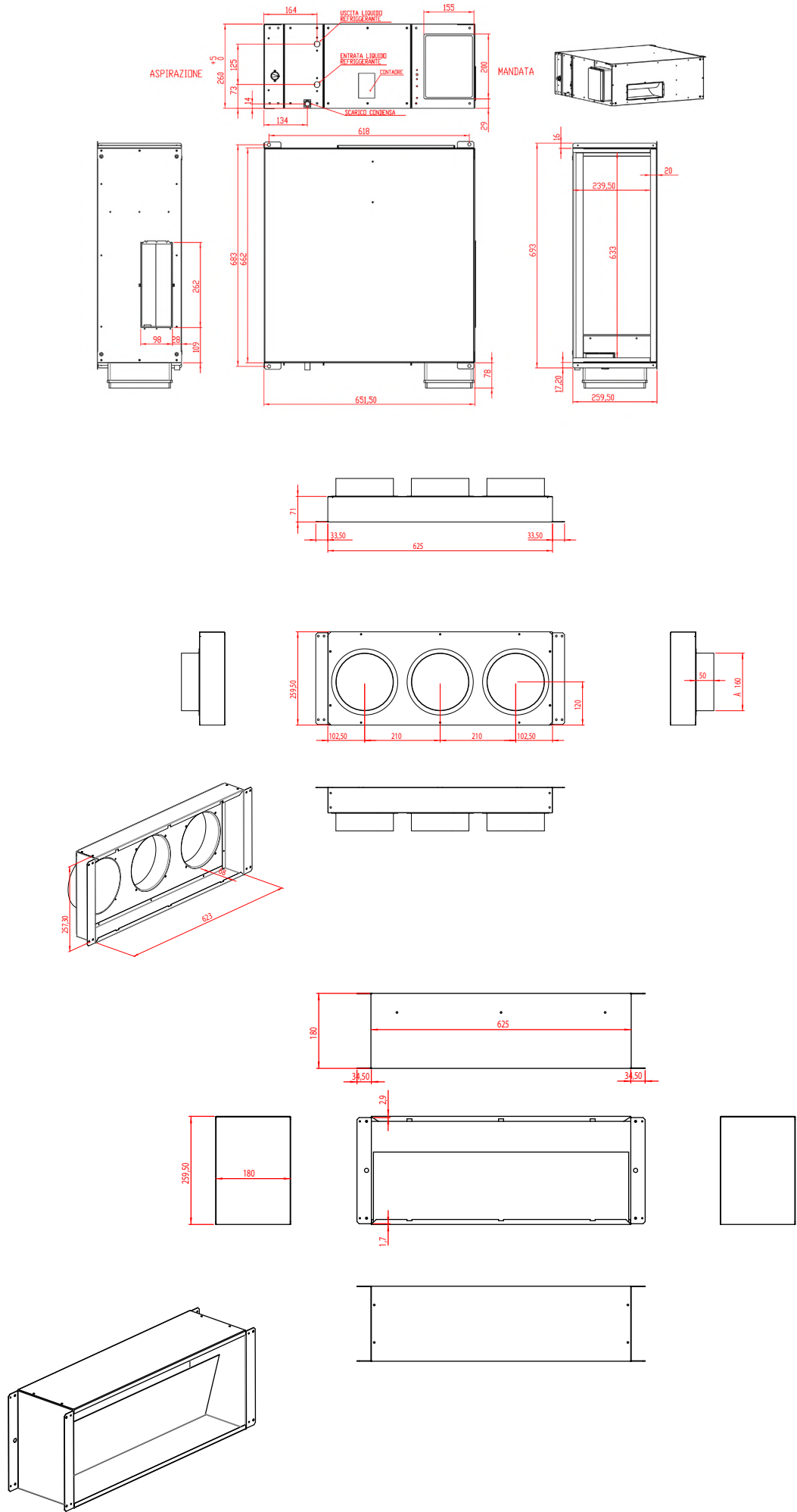

**TECNOKLIMA SRL**

Air treatment for companies and individuals

Administrative headquarters and warehouse:  
Via della Repubblica, 1 ABCD  
40057 Granarolo dell'Emilia (BO) Italy

Telephone +39 051/6056846 - 051/6066593  
Email [info@tecnoklima.it](mailto:info@tecnoklima.it)  
Web [www.tecnoklima.it](http://www.tecnoklima.it)

 **Tecnoklima**

The manufacturer reserves the right to make improvements to its products without notice. Features may vary depending on changes made for any customizations.